

SECTION: 32 & 5	TOWNSHIP: 1 and 2 South	RANGE: 10 West
COUNTY: Tillamook		DATE: 8/14/2023
CORNER DESIGNATION:		(Please check one)
Quarter corner common to Section 32, Township 1 South, and Section 5, Township 2 South, Range 10 West; Willamette Meridian.		<input checked="" type="checkbox"/> Condition Report Only
		<input type="checkbox"/> Restoration
		<input type="checkbox"/> Rewitness
		<input type="checkbox"/> Unrecorded
		<input type="checkbox"/> Reset at surface
		<input type="checkbox"/> Referenced Out

Previous Rewitnesses, Restorations and Surveys, etc... GLO (1856), Rewitness bk10 pg71 (1889), S3- 210 (1899), Rewitness bk4 pg31 (1924), field bk p-9 pg171 (1924), A-231, Rewitness bk1 pg91 (1950), Rewitness bk2 pg394 (1956), Rewitness bk3 pg305 (1969), B-583 (1969), A-1973 (1970), A-2443 (1973), B-658 (1974), B-659 (1974), B-786 (1978), Rewitness card # 332 (1978), B-935 (1980), B-1781 (1994), B-1815 (1994), A-7074 (1995), p-461 (1998), C-537 (2006), F-21-7, F-40-125

History, condition, and sources: Samuel D Snowden under GLO contracts 66 and 67 set a post for the quarter section corner common to sections 32 T. 1S, R. 10W and section 5, T.2S, R.10W and referenced 2 bearing trees. In 1889 (Rewitness bk 10 pg71) A.M. Austin set post for corner and added 2 bearing trees. In 1924 (Rewitness bk4 pg31) W.E. Anderson set post for ¼ corner and added 2 bearing trees. In 1950 (Rewitness Bk1 pg91) W.E Anderson visited the corner, found one record bearing tree, and added one new one. In 1956 (Rewitness Bk2 pg394) Charles G. Collard found one of Andersons bearing trees down with corner post still attached to root wad. Collard set a ¾" Iron pipe with 1 ½" babbitted cap stamped "T.1S. T.2S. SEC 5 ¼ R10W SEC 32" as shown hereon. Collard also added two new bearing trees. In 1969 (Rewitness bk3 pg305) Charles Collard visited the corner he had previously set found it to be in good condition and added 2 new bearing trees. In 1978 the Tillamook County Surveyors Office visited the corner added 10" tile around corner monument and filled it with cement along with a hat section post with yellow metal location tag. In 2023 The Tillamook County Surveyors Office found the 1 ½" babbitted cap surrounded by 10" tile filled with concrete and found 3 record bearing trees as noted below. The Surveyors office also established 2 new bearing trees and installed a new hat section post as described below.

- Found: (Rewitness card #332) (10" Hemlock North 7') Now 28" Hemlock N 5 1/2° W 6' added yellow metal location tag
- Not Found: (Rewitness card #332) (12" Alder S 74° W 37.7')
- Found: (Rewitness card #332) (7' Spruce stump with tag N 19° W 24.4') Badly rotted stump no tag
- Found: (Rewitness card #332) (16" Hemlock S 40° 40' E 80.2') Badly rotted stump 4' high
- Found: (Rewitness card #332) 10" Tile and concrete around Tillamook County Brass Cap

New accessories set:

- 96" Hat section post with yellow metal location tag South 3.5'
 - 18" Alder scribed "T1SR10W1/4BT" with nail and "TILL CO. SURVEYOR" washer between the B&T with yellow metal location tag. N 55° E 17.27'
 - 64" spruce scribed "T2SR10W1/4BT" with nail and "TILL CO SURVEYOR" washer between the B&T with yellow metal location tag S 20 1/2° E 66.11'
- The Monument was tied conventionally using G.P.S. established control. The coordinates have been converted and are provided here in WGS 84, Latitude and Longitude.
- Latitude: 45° 26' 06.3"
Longitude: - 123° 56' 17.8"

Pictures of Found Monuments:



Location: ±275' East of Holley Heights cul-de-sac

Tillamook County Surveyor office: 1510 3rd Street Suite C, Tillamook, OR. 97141

Party Chief: Travis Porter Tillamook County Survey Supervisor

Witnesses: Michael R. Rice, PLS Tillamook County Surveyor, Kael Poklikuha Tillamook County Survey Tech.

Notes: Digital images taken of monument and accessories.

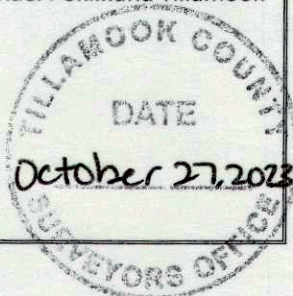

SURVEYOR'S SEAL

